

# Trim and Stabilisation

One package - All speeds - One supplier

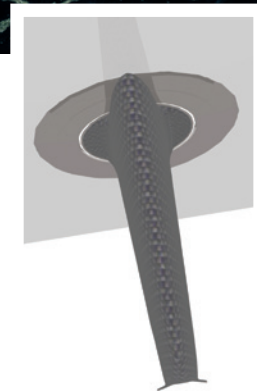

Fully electric - Fin and interceptor integration - Ultra compact



**HUMPHREE®**  
Trim and Stabilisation Systems

**World  
Premiere!**

# Trim and stabilisation in one package

Combining Humphree's market leading ultra-fast electric interceptors with our NEW state of the art 24V DC electric powered fin stabilisers Humphree delivers a game changing package where both roll, pitch and yaw motions are controlled by one system.

The system will control the trim of the boat for best performance and lowest fuel burn when the boat is in operation. It will stabilise roll motions at all speeds using a combination of interceptors and fins. The integration also provides a new level of comfort during turns with Humphree's Coordinated Turn functionality.

This is the new generation!

## Stabilisation without a genset engine

As this new system is 100% powered by 24V DC, the system can be operated without keeping a genset engine running while underway. The main engine alternator will be enough to charge the batteries powering the system. Less noise, less fuel burn.

## A smart, safe and easy installation

A smart solution using 24V DC power means that no large and heavy AC power box has to be installed and no hydraulic hoses or pumps are needed. Once the actuators are in place, simply connect to the DC power. All communication cables are delivered in the package with plug and play watertight connectors. Plug and play.

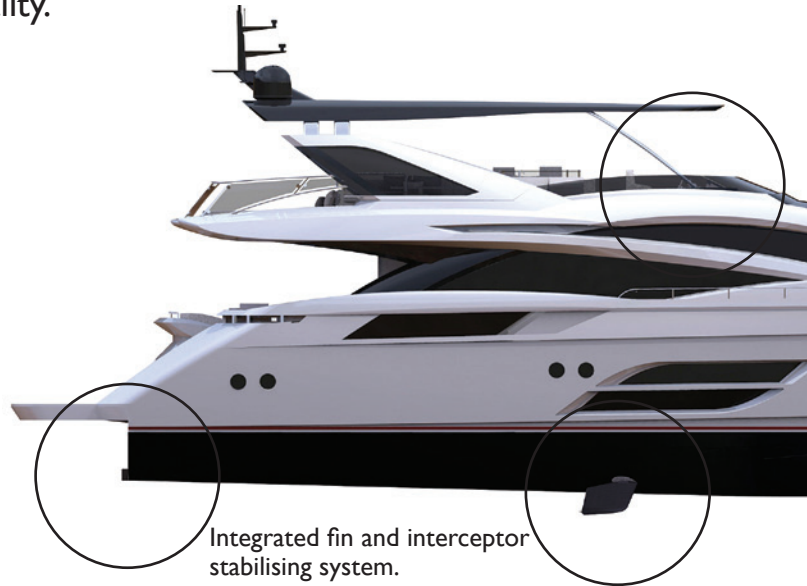

Improved comfort while stabilised at anchor



Improved comfort at turns using Coordinated Turn

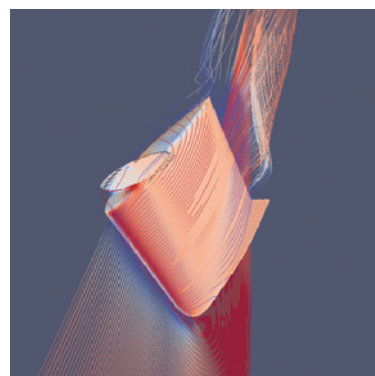
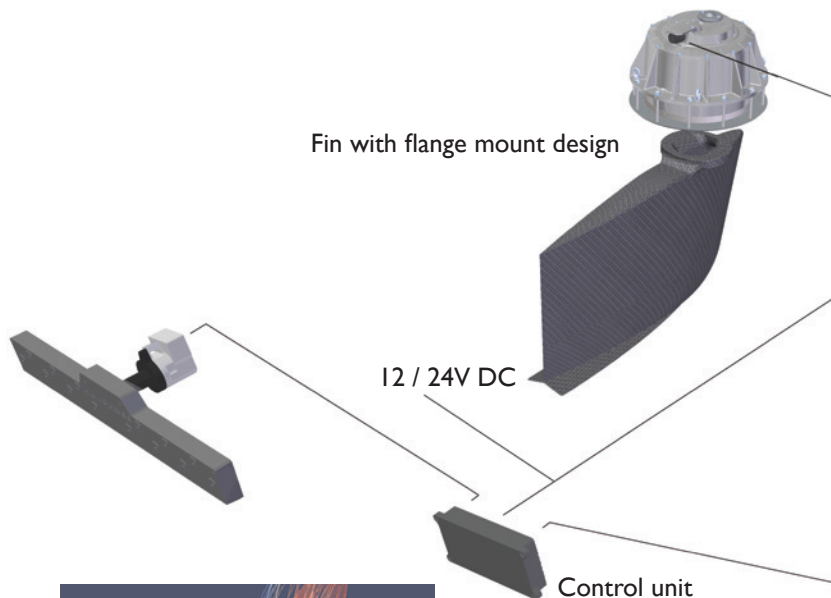

Superior hydrodynamic design

# age - at all speeds from one supplier



## Stabilisation at all speeds

The combined fin and interceptor system provides full roll stabilisation at all speeds, from zero and low speeds all the way up to top speed. Compared to other systems in the market, this unique combination of interceptors and fins also stabilise both roll and pitch motions underway. Enjoy the maximum comfort of the new generation!

## Sturdy and robust, low built in height and remarkably low weight

The new sturdy patented servo actuators are extremely compact. The space requirement inside the vessel is less than the most compact hydraulic fin stabilizer systems on the market. A depth of only 310mm from exterior mounting flange. Also, compared to the competition, the Humphree system is at least 25%, and typically, 50% less weight than other systems.



The control panels gives you easy access to the new system.



Servo unit SU553

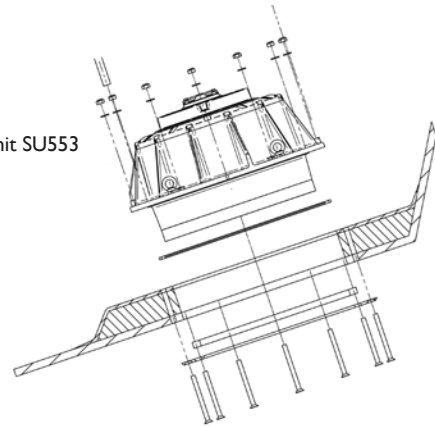

The fin has a back cut to allow a break function and clearance from hull structure such as stringers.

Control panel  
Control unit

Ultra fast 24V DC actuators



Integrated ultra fast interceptors

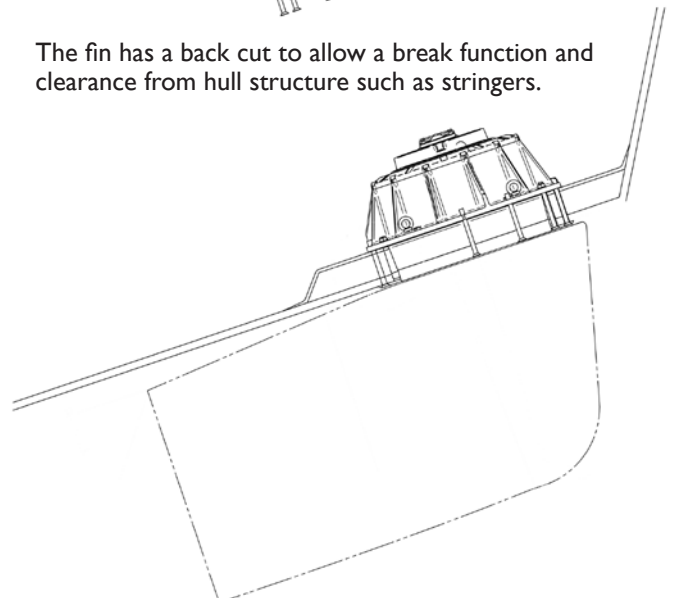
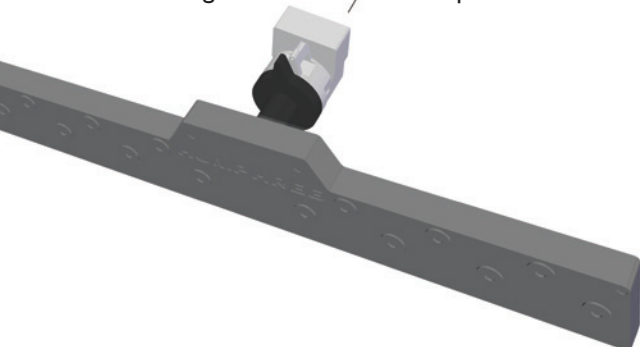

## Underwater replacable fin, designed for safety

In the event of a fin strike, the fin is engineered to break away while maintaining the integrity of the hull structure. Furthermore, the unique flange mount design allows for a new fin to be installed underwater without the need to haul the vessel. Practical, smart, safe, Humphree is intelligent engineering.

# Electric Stabilising Fin

## Fin Data:

Fin Size:	0,4m <sup>2</sup> , 0,6m <sup>2</sup> , 1m <sup>2</sup>
Material:	Carbon and GRP
Weight:	30kg,(0,4m <sup>2</sup> ) 40kg,(0,6m <sup>2</sup> ) 60kg.(1m <sup>2</sup> )

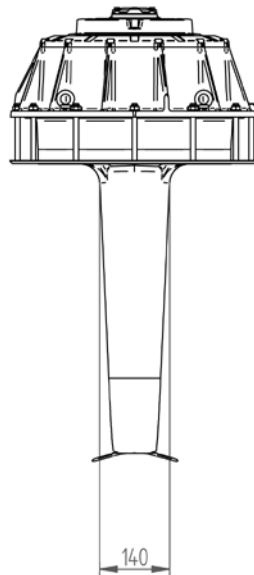
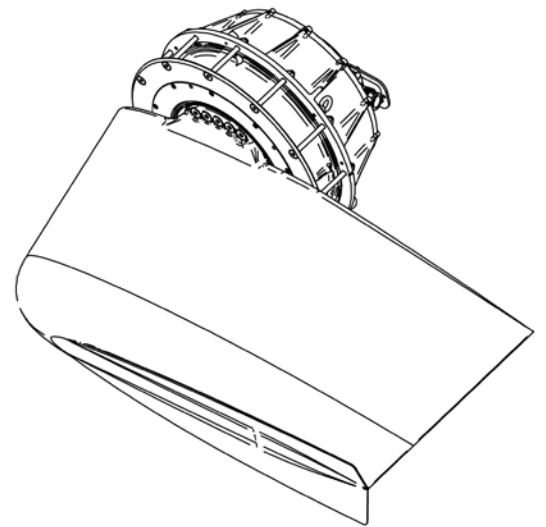
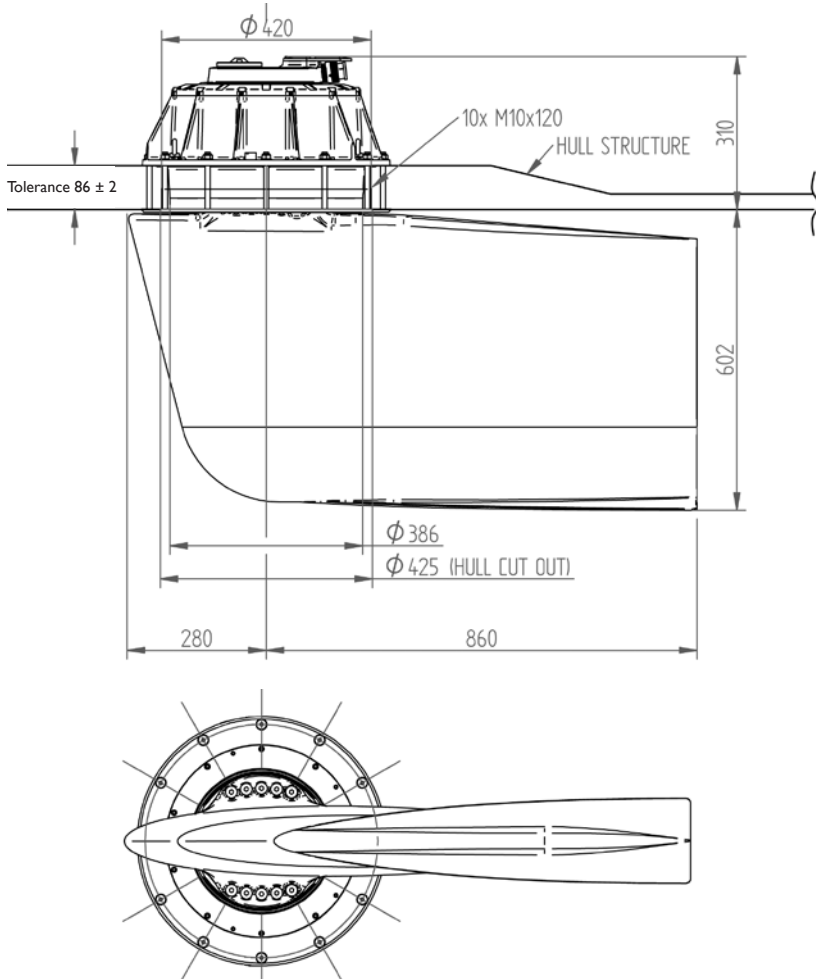

## SU553 Servo Data:

Materials inside hull:	Aluminium housing
Materials outside hull:	Stainless steel (Duplex)
Motor:	Brushless Servo motor
Power supply:	24-32 V DC
Weight:	102kg
Max peak power consumption:	5kW
Max continous power consumption:	2kW (80 A)(RMS)
Fin rotational speed:	Up to 90°/s
Communication:	HCS5 Integrated
Possible rotation	360°

(Illustrations are showing 0,6m<sup>2</sup> fin)

# HUMPHREE®

[www.humphree.com](http://www.humphree.com) - for your closest Humphree representative

The information contained in this leaflet is subject to change without notification.

Copyright © Humphree 2015. All rights reserved.